

Tyco / Electronics
Raychem Circuit Protection
 308 Constitution Drive
 Menlo Park, CA 94025-1164
 Phone: 800-227-4856
 Fax: 800-227-4866

PolySwitch®
PTC Devices
 Overcurrent Protection Device

PRODUCT: TS600-170

DOCUMENT: SCD 24101
 PCN: 220973, C25172
 REV LETTER: G
 REV DATE: OCTOBER 28, 2003
 PAGE NO.: 1 OF 1

Specification Status: RELEASED

Max Electrical Rating at 20°C

Operating Voltage: **60V_{DC}**
 Fault Voltage: **600V_{RMS}**
 Interrupt Current: **3A_{RMS}**

Terminal Material: Sn plated brass
Case Material: 1000 V Dielectric rating

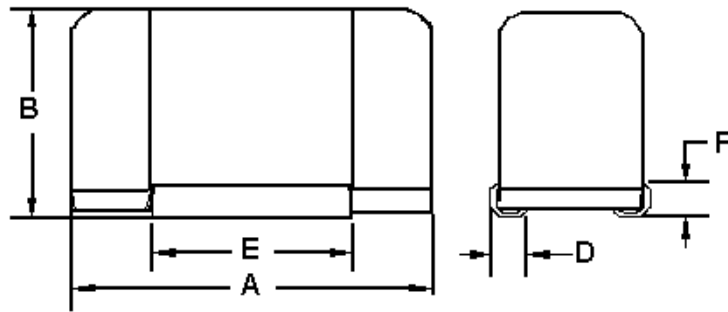
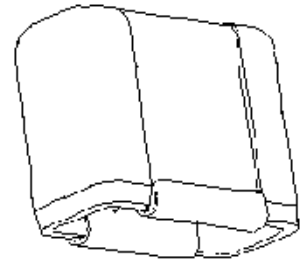
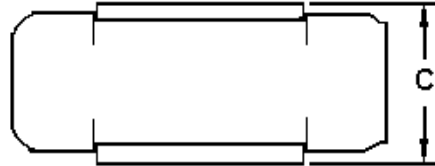

Marking:

- Raychem Logo
- XX T20 — Part Identification
- — Lot Identification

TABLE I. DIMENSIONS:

	A		B		C		D		E		F	
	MIN	MAX	MIN	MAX	MIN	MAX	MIN	MAX	MIN	MAX	MIN	MAX
mm:	18.29	19.43	11.56	12.32	7.24	8.26	1.65	2.41	9.91	10.41	1.52	2.29
in*:	(0.720)	(0.765)	(0.455)	(0.485)	(0.285)	(0.325)	(0.065)	(0.095)	(0.390)	(0.410)	(0.060)	(0.090)

*Rounded off approximation

TABLE II. PERFORMANCE RATINGS @ 20°C (unless otherwise noted):

IHOLD (mA)		RESISTANCE (Ω)				TIME TO TRIP (s)	OPERATING Temperature (°C)		Power Dissipation
20°C	70°C	R MIN	R MAX	R ₁ Inst*	R ₁ MAX**	@ 1A TYP	MIN	MAX	Watts, Typical
170	90	4.0	9.0	18.0	18.0	10	-40	85	2.5

*Post Reflow Resistance, measured after one hour.

**Maximum device resistance at 20°C measured 1 hour post trip.

Agency Recognition: CSA, UL Recognition file #E74889
 Reference Documents: PS300
 Precedence: This specification takes precedence over documents referenced herein.
 Effectivity: Reference documents shall be the issue in effect on the date of invitation for bid.
 CAUTION: Operation beyond the rated voltage or current may result in rupture, electrical arcing or flame.