



Specification Status: Released

Max Electrical Rating at 20°C

Operating Voltage: 250V_{DC}
Fault Voltage: 600V_{RMS}
Interrupt Current: 3A_{RMS}

Lead Material :
 22 AWG Sn/Pb plated copper

Marking:

- 
Raychem Logo and Voltage
- 160
— Part Identification
- 
— Lot Identification

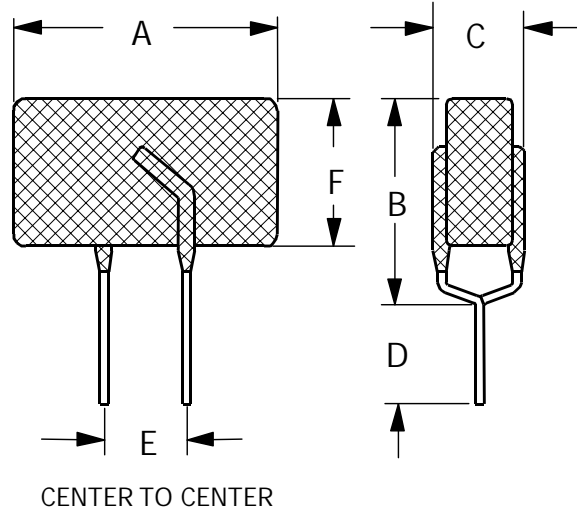

TABLE I. DIMENSIONS:

	A		B		C		D		E	F	
	MIN	MAX	MIN	MAX	MIN	MAX	MIN	MAX	NOM	MIN	MAX
mm:	--	16.0	--	12.6	--	6.0	4.7	--	5.0		10.0
in:	--	(0.630)	--	(0.496)	--	(0.236)	(0.185)	--	(0.197)		(0.394)

TABLE II. PERFORMANCE RATINGS @ 20°C (unless otherwise noted):

I HOLD (A)		RESISTANCE (Ω)			TYPICAL TIME TO TRIP (S) @ 1A TYP	OPERATING TEMPERATURE (°C)	
20°C	60°C	R MIN	R MAX	R _{1 MAX} *		MIN	MAX
0.160	0.100	4.0	7.0	16.0	9.5	-40	85

* Maximum device resistance @ 20°C measured 1 hour post trip.

Storage Temperature: -40° to 85°C

Reference Documents: PS300
 Precedence: This specification takes precedence over documents referenced herein.
 Effectivity: Reference documents shall be the issue in effect on the date of invitation for bid.
 CAUTION: Operation beyond the rated voltage or current may result in rupture, electrical arcing or flame.