

Tyco / Electronics
Raychem Circuit Protection
 308 Constitution Drive
 Menlo Park, CA 94025-1164
 Phone: 800-227-4856
 Fax: 800-227-4866

PolySwitch®
PTC Devices
 Overcurrent Protection Device

PRODUCT: TR600-160

DOCUMENT: SCD 22470
 PCN: 934973
 REV LETTER: N
 REV DATE: MAY 15, 2003
 PAGE NO.: 1 OF 1

Specification Status: Released

Max Electrical Rating at 20°C

Operating Voltage: 250V_{DC}
Fault Voltage: 600V_{RMS}
Interrupt Current: 3A_{RMS}

Lead Material:
 22 AWG Sn/Pb plated copper

Marking:

Raychem Logo and Voltage
 X 600
 160 — Part Identification
 □ □ □ □ — Lot Identification

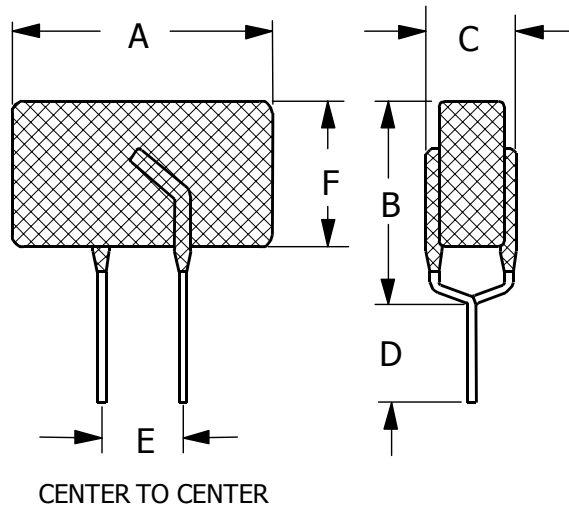

TABLE I. DIMENSIONS:

	A		B		C		D		E	F
	MIN	MAX	MIN	MAX	MIN	MAX	MIN	MAX	NOM	MAX
mm:	--	16.0	--	12.6	--	6.0	4.7	--	5.0	10.0
in:	--	(0.630)	--	(0.496)	--	(0.236)	(0.185)	--	(0.197)	(0.394)

TABLE II. PERFORMANCE RATINGS @ 20°C (unless otherwise noted):

IHOLD (A)		RESISTANCE (Ω)			TIME TO TRIP (s) @ 1A		OPERATING TEMPERATURE (°C)	
20°C	60°C	R MIN	R MAX	R _{1 MAX} *	TYP	MAX	MIN	MAX
0.160	0.100	4.0	10.0	18.0	7.5	18.0	-40	85

*Maximum device resistance at 20°C measured 1 hour post trip.

Agency Recognition: UL, CSA
 Reference Documents: PS300
 Precedence: This specification takes precedence over documents referenced herein.
 Effectivity: Reference documents shall be the issue in effect on the date of invitation for bid.
 CAUTION: Operation beyond the rated voltage or current may result in rupture, electrical arcing or flame.