

Tyco / Electronics
Raychem Circuit Protection
 308 Constitution Drive
 Menlo Park, CA 94025-1164
 Phone: 800-227-4856
 FAX 800-227-4866

PolySwitch®
PTC Devices
 Overcurrent Protection Device

PRODUCT: TR600-150- RA

DOCUMENT: SCD 25046
 PCN: 243496
 REV LETTER: A
 REV DATE: JULY 24, 2002
 PAGE NO.: 1 OF 1

Specification Status: Released

Max Electrical Rating at 20°C

Operating Voltage: 60V_{DC}
Fault Voltage: 600V_{RMS}
Interrupt Current: 3A_{RMS}

Lead Material :
 22 AWG Sn/Pb plated copper

Marking:

Raychem Logo and Voltage
 Part Identification
 Lot Identification

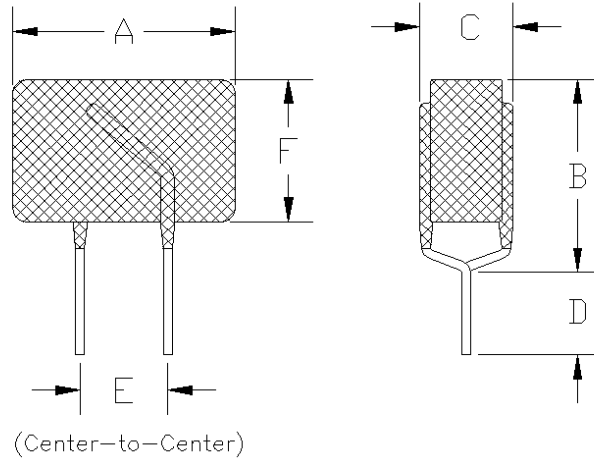

TABLE I. DIMENSIONS:

	A		B		C		D		E	F	
	MIN	MAX	MIN	MAX	MIN	MAX	MIN	MAX	NOM	MIN	MAX
mm:	--	13.5	--	12.6	--	6.0	4.7	--	5.0	--	10.0
in:	--	(0.531)	--	(0.496)	--	(0.236)	(0.185)	--	(0.197)	--	(0.185)

TABLE II. PERFORMANCE RATINGS @ 20°C (unless otherwise noted):

I HOLD (A)		RESISTANCE (Ω)			TYPICAL TIME TO TRIP (s) @ 1A		OPERATING TEMPERATURE (°C)	
20°C	60°C	R MIN	R MAX	R ₁ MAX*	TYP	MAX	MIN	MAX
0.150	0.090	7.0	10.0	20.0	5.0	7.5	-40	85

*Maximum device resistance at 20°C measured 1 hour post trip.

Designed for UL60950 applications.

Agency Recognitions: UL, CSA
 Reference Documents: PS300
 Precedence: This specification takes precedence over documents referenced herein.
 Effectivity: Reference documents shall be the issue in effect on the date of invitation for bid.
 CAUTION: Operation beyond the rated voltage or current may result in rupture, electrical arcing or flame.