

Tyco / Electronics
Raychem Circuit Protection
 308 Constitution Drive
 Menlo Park, CA 94025-1164
 Phone: 800-227-4856
 Fax: 800-227-4866

PolySwitch®
PTC Devices
 Overcurrent Protection Device

PRODUCT: TR250-120T-RA

DOCUMENT: SCD 25049
 PCN: 158645
 REV LETTER: B
 REV DATE: JANUARY 26, 2004
 PAGE NO.: 1 OF 1

Specification Status: Released

Max Electrical Rating at 20°C

Operating Voltage: 60V_{DC}
Fault Voltage: 250V_{RMS}
Interrupt Current: 3A_{RMS}

Lead Material :
 22 AWG Sn/Pb plated copper

Marking:

- Raychem Logo
- XX 20 — Part Identification
- — Lot Identification

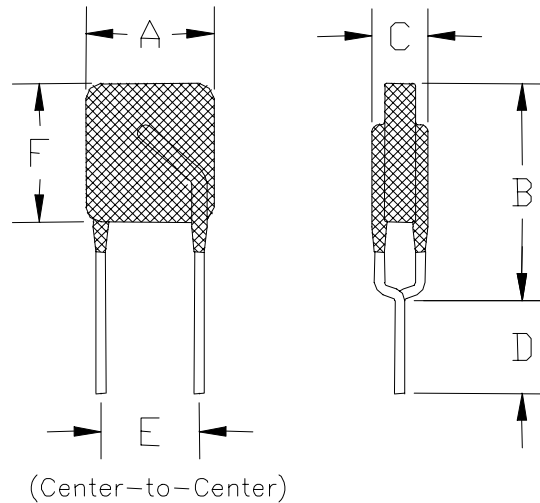

TABLE I. DIMENSIONS:

	A		B		C		D		E	F	
	MIN	MAX	MIN	MAX	MIN	MAX	MIN	MAX	NOM	MIN	MAX
mm:	--	6.5	--	11.0	--	4.6	4.7	--	5.0	--	7.0
in:	--	(0.256)	--	(0.433)	--	(0.180)	(0.185)	--	(0.197)	--	(0.276)

TABLE II. PERFORMANCE RATINGS @ 20°C (unless otherwise noted):

IHOLD (A)		RESISTANCE (Ω)			TIME TO TRIP (s) @ 1A		OPERATING TEMPERATURE (°C)	
20°C	40°C	R MIN	R MAX	R _{1 MAX} *	TYP	MAX	MIN	MAX
0.120	0.110	7.0	9.0	16.0	0.70	1.0	-40	85

*Maximum device resistance at 20° C measured 1 hour post trip.

Additional Ratings @ 20°C

Lightning Withstand ITU AT 1.5kV

Agency Recognition: UL, CSA, TUV

Reference Documents: PS300

Precedence: This specification takes precedence over documents referenced herein.

Effectivity: Reference documents shall be the issue in effect on the date of invitation for bid.

CAUTION: Operation beyond the rated voltage or current may result in rupture, electrical arcing or flame.