

Specification Status: Released

Max Electrical Rating at 20°C

Operating Voltage: 60V_{DC}
Fault Voltage: 250V_{RMS}
Interrupt Current: 3A_{RMS}

Lead Material :
 22 AWG Sn/Pb plated copper

Marking:

- _____ Raychem Logo
- ⊗ 20 _____ Part Identification
- _____ Lot Identification

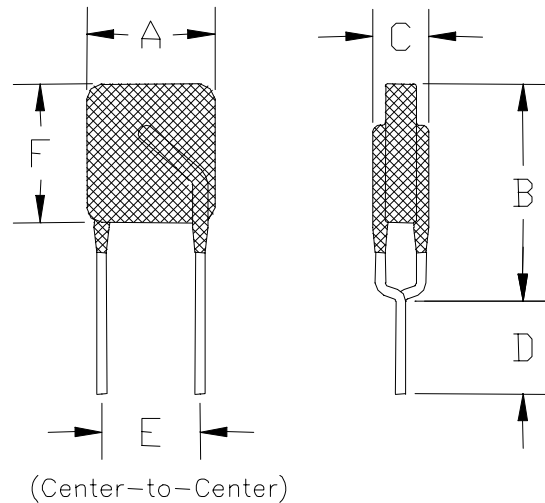

TABLE I. DIMENSIONS:

	A		B		C		D		E	F	
	MIN	MAX	MIN	MAX	MIN	MAX	MIN	MAX	NOM	MIN	MAX
mm:	--	6.5	--	11.0	--	4.6	2.55	--	5.0	--	7.0
in:	--	(0.256)	--	(0.433)	--	(0.180)	(0.100)	--	(0.197)	--	(0.276)

TABLE II. PERFORMANCE RATINGS @ 20°C (unless otherwise noted):

IHOLD (A) (TYP) 20°C	RESISTANCE (Ω)			TIME TO TRIP (s) @ 1A		OPERATING TEMPERATURE (°C)	
	R MIN	R MAX	R _{1 MAX} *	TYP	MAX	MIN	MAX
0.120	6.0	9.0	16	0.8	1.2	-40	85

* Maximum device resistance at 20°C measured 1 hour post trip.

Additional Ratings @ 20°C

Lightning Withstand ITU AT 1.5Kv

Agency Recognition: UL, CSA, TUV

Reference Documents: PS300

Precedence: This specification takes precedence over documents referenced herein.

Effectivity: Reference documents shall be the issue in effect on the date of invitation for bid.

CAUTION: Operation beyond the rated voltage or current may result in rupture, electrical arcing or flame.