

**Tyco / Electronics**  
**Raychem Circuit Protection**  
 308 Constitution Drive  
 Menlo Park, CA 94025-1164  
 Phone: 800-227-4856  
 Fax: 800-227-4866

**PolySwitch®**  
**PTC Devices**  
**Overcurrent Protection Device**

**PRODUCT: TR600-150-RB**

DOCUMENT: SCD 24064  
 PCN: 688511  
 REV LETTER: D  
 REV DATE: OCTOBER 23, 2002  
 PAGE NO.: 1 OF 1

**Specification Status: Released**

**Max Electrical Rating at 20°C**

**Operating Voltage: 60V<sub>DC</sub>**  
**Fault Voltage: 600V<sub>RMS</sub>**  
**Interrupt Current: 3A<sub>RMS</sub>**

Lead Material :  
 22 AWG Sn/Pb plated copper

**Marking:**

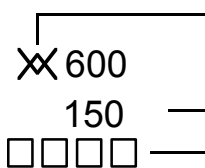
 Raychem Logo and Voltage  
**XX 600**  
 150 — Part Identification  
 □□□□ — Lot Identification

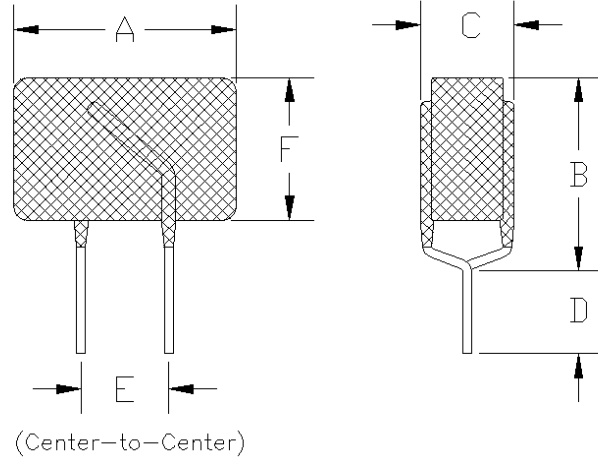

**TABLE I. DIMENSIONS:**

	A		B		C		D		E	F	
	MIN	MAX	MIN	MAX	MIN	MAX	MIN	MAX	NOM	MIN	MAX
mm:	--	13.5	--	12.6	--	6.0	4.7	--	5.0	--	10.0
in:	--	(0.531)	--	(0.496)	--	(0.236)	(0.185)	--	(0.197)	--	(0.394)

**TABLE II. PERFORMANCE RATINGS @ 20° C (unless otherwise noted):**

IHOLD (A)		RESISTANCE (Ω)			TIME TO TRIP (S) @ 1A TYP	OPERATING TEMPERATURE (°C)	
20° C	60° C	R MIN	R MAX	R <sub>1 MAX</sub> *		MIN	MAX
0.150	0.090	9.0	12.0	22.0	4.5	-40	85

\* Maximum device resistance at 20°C measured 1 hour post-trip.

Storage Temperature: -40° to 85°C

Agency Recognition: UL, CSA

Reference Documents: PS300

Precedence: This specification takes precedence over documents referenced herein.

Effectivity: Reference documents shall be the issue in effect on the date of invitation for bid.

CAUTION: Operation beyond the rated voltage or current may result in rupture, electrical arcing or flame.