

### Specification Status: Released

**Electrical Rating**

Voltage: 14 Vdc MAX  
Current: 100 A MAX

**Terminal Material:**

Brass H65  
Thickness: 0.8mm  
Tin plating thickness: 5µm

**Insulating Material:**

Red color PBT, Meets  
UL94V-0 Requirements

**Marking:**

- ⊗ - Manufacturer's Mark
- 14VDC - Voltage Rating
- BD280-1130-10 - Part ID
- - Lot Number

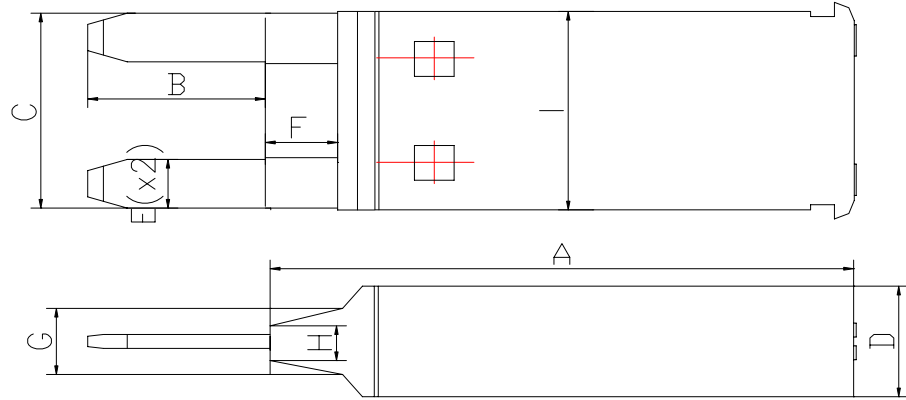

**TABLE I. DIMENSIONS:**

	A		B		C		D		E(x2)		F	
	MIN	MAX	MIN	MAX	MIN	MAX	MIN	MAX	MIN	MAX	MIN	MAX
mm:	29.5	30.1	8.7	9.3	10.75	11.25	6.05	6.65	2.55	3.05	3.3	3.9
in*:	(1.173)	(1.185)	(0.343)	(0.366)	(0.423)	(0.443)	(0.238)	(0.262)	(0.1)	(0.12)	(0.13)	(0.154)

	G		H		I	
	MIN	MAX	MIN	MAX	MIN	MAX
	3.4	4	1.7	2.3	10.9	11.5
	(0.134)	(0.157)	(0.067)	(0.091)	(0.429)	(0.453)

\*Rounded off approximation

**TABLE II: PERFORMANCE RATINGS:**

INITIAL RESISTANCE VALUES		TIME TO TRIP AT 40AMPS	TRIP CURRENT AT Rmin	R1max ONE-HOUR POST-TRIP RESISTANCE	HOLD CURRENT AT R1max	TRIPPED-STATE POWER DISSIPATION
OHMS AT 25°C MIN	OHMS AT 25°C MAX	SECONDS AT 25°C MAX	AMPS AT 25°C MAX	OHMS AT 25°C MAX	AMPS AT 25°C MIN	WATTS AT 20°C, 14V TYP
0.0095	0.0135	8.0	13.0	0.0185	8.0	4.4

Reference Documents:

PS300, PS400 & SAE-J2685

Precedence:

This specification takes precedence over documents referenced herein.

Effectivity:

Reference documents shall be the issue in effect on the date of invitation or bid.

CAUTION:

Operation beyond the rated voltage or current may result in rupture, electrical arcing or flame.

**Materials Information**

ROHS Compliant

ELV Compliant

Pb-Free

