

Specification Status: Released

Electrical Rating

Voltage: 12V MAX
Current: 100A MAX

Leads:
 Nickel: 0.13mm nom

Tape:
 Polyester

Marking:
 _____ Manufacturer's Mark
 ✕ R23 _____ Part Identification
 □□□□ _____ Lot Identification

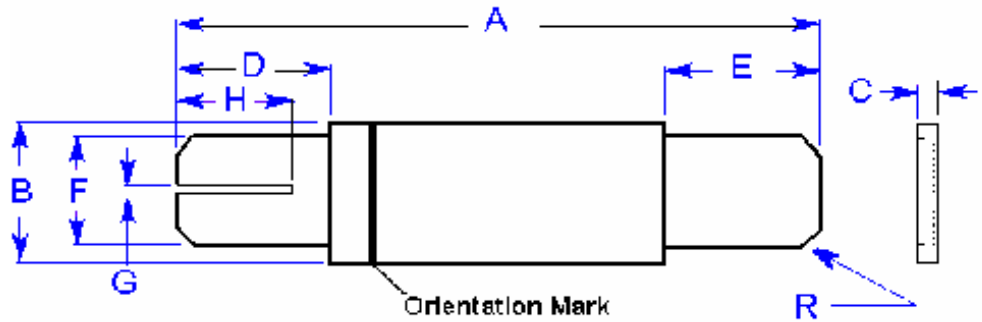

TABLE I. DIMENSIONS:

A		B		C		D		E		F		G		
MIN	MAX	MIN	MAX	MIN	MAX	MIN	MAX	MIN	MAX	MIN	MAX	MIN	MAX	
mm:	20.9	23.1	4.9	5.3	-	0.8	4.1	5.8	4.1	5.8	3.9	4.1	0.3	0.7
in*:	(0.82)	(0.91)	(0.19)	(0.21)	-	(0.03)	(0.16)	(0.23)	(0.16)	(0.23)	(0.15)	(0.16)	(0.01)	(0.03)

H		J		K		L		M		N		R	
MIN	MAX	MIN	MAX	MIN	MAX	MIN	MAX	MIN	MAX	MIN	MAX	TYP	MAX
mm:	3.8	4.2	--	--	--	--	--	--	--	--	--	1.0	--
in*:	(0.15)	(0.17)	--	--	--	--	--	--	--	--	--	(0.039)	--

*Rounded off approximation

TABLE II. PERFORMANCE RATINGS:

I HOLD	CURRENT TRIP LIMITS								TIME TO TRIP		REFERENCE RESISTANCE		ONE-HOUR POST-TRIP RESISTANCE		TRIPPED-STATE POWER DISSIPATION	
	AMPS AT 0°C HOLD		AMPS AT 25°C HOLD TRIP		AMPS AT 60°C HOLD TRIP		AMPS AT 80°C HOLD TRIP		SECONDS AT 25°C, 10.0 A TYP MAX		OHMS AT 25°C MIN MAX		OHMS AT 25°C TYP MAX		WATTS AT 25°C, 12V TYP MAX	
2.3	3.4	6.6	2.3	5.0	0.9	2.3	-	-	2.4	5	0.012	0.018	0.031	0.036	1.4	2.5

Reference Documents: PS300
 Precedence: This specification takes precedence over documents referenced herein.
 Effectivity: Reference documents shall be the issue in effect on the date of invitation for bid.
 CAUTION: Operation beyond the rated voltage or current may result in rupture, electrical arcing or flame.