

**Tyco / Electronics**  
**Raychem Circuit Protection**  
 308 Constitution Drive  
 Menlo Park, CA 94025-1164  
 Phone: 800-227-4856  
 Fax: 800-227-4866

**PolySwitch®**  
**PTC Devices**  
 Overcurrent Protection Device

**PRODUCT: VLR170**

DOCUMENT: SCD 24524  
 PCN: 909270  
 REV LETTER: D  
 REV DATE: MARCH 12, 2003  
 PAGE NO.: 1 OF 1

**Specification Status: Released**

**Electrical Rating**

**Voltage: 12V MAX**  
**Current: 100A MAX**

**Leads:**

Nickel: 0.125 mm nom.

**Tape:**

Polyester

**Marking:**

- Manufacturer's Mark
- ⊗ R17 — Part Identification
- □ □ □ — Lot Identification

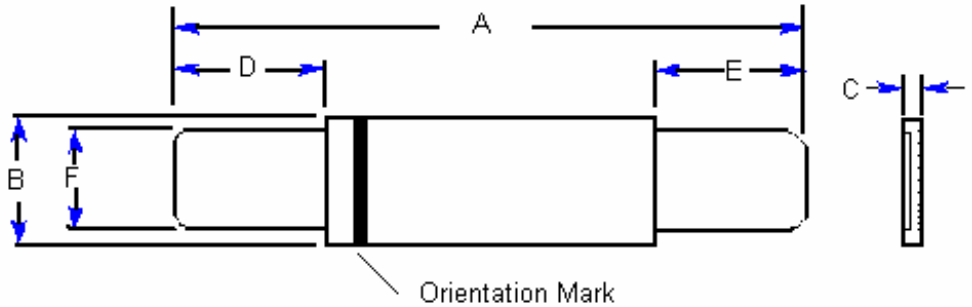

**TABLE I. DIMENSIONS:**

	A		B		C		D		E		F	
	MIN	MAX	MIN	MAX	MIN	MAX	MIN	MAX	MIN	MAX	MIN	MAX
mm:	20.8	23.2	3.5	3.9	--	0.8	4.5	6.5	4.5	6.5	2.4	2.6
in*:	(0.82)	(0.91)	(0.14)	(0.15)	--	(0.03)	(0.18)	(0.26)	(0.18)	(0.26)	(0.09)	(0.10)

\*Rounded off approximation

**TABLE II. PERFORMANCE RATINGS:**

I HOLD	CURRENT TRIP LIMITS						TIME TO TRIP	REFERENCE RESISTANCE		ONE-HOUR POST-TRIP RESISTANCE		TRIPPED-STATE POWER DISSIPATION	
	AMPS AT 0°C		AMPS AT 25°C		AMPS AT 60°C			OHMS AT 25°C		OHMS AT 25°C		WATTS AT 25°C, 12V	
25°C HOLD	AMPS HOLD	AMPS TRIP	AMPS HOLD	AMPS TRIP	AMPS HOLD	AMPS TRIP	SECONDS AT 25°C, 8.5 A MAX	MIN	MAX	MIN	MAX	TYP	MAX
1.7	2.4	5.6	1.7	4.1	0.7	1.9	5.0	0.018	0.032	0.018	0.064	-	1.4

**Reference Documents:**

PS300

**Precedence:**

This specification takes precedence over documents referenced herein.

**Effectivity:**

Reference documents shall be the issue in effect on the date of invitation for bid.

**CAUTION:**

Operation beyond the rated voltage or current may result in rupture, electrical arcing or flame.