

Tyco/Electronics
Raychem Circuit Protection
 308 Constitution Drive
 Menlo Park, CA 94025-1164
 Phone: 800-227-4856
 Fax: 800-227-4866

PolySwitch®
PTC Devices
 Overcurrent Protection Device

PRODUCT: TRF600-150

DOCUMENT: SCD 25092
 PCN: A87878
 REV LETTER: G
 REV DATE: APRIL 9, 2004
 PAGE NO.: 1 OF 1

Specification Status: RELEASED

Max Electrical Rating at 20°C

Operating Voltage: 250V_{DC}

Fault Voltage: 600V_{RMS}

Interrupt Current: 3A_{RMS}

Lead Material: 100% Tin plated copper

Marking:

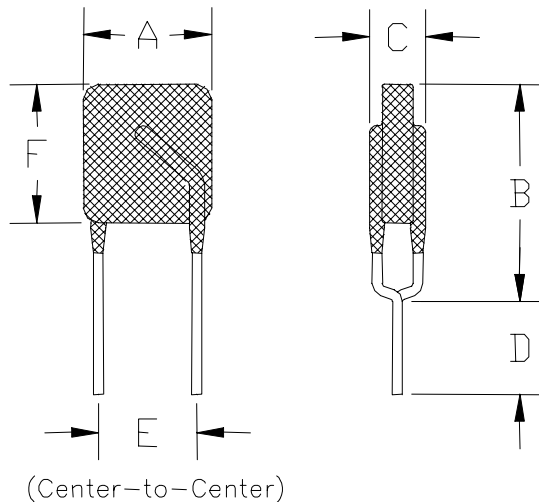
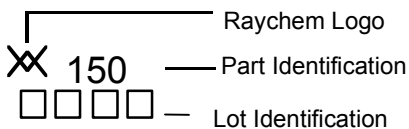

TABLE I. DIMENSIONS

	A		B		C		D		E	F	
	Min	Max	Min	Max	Min	Max	Min	Max	Nom	Min	Max
mm:	--	9.0	--	12.5	--	4.6	4.7	--	5.0	--	9.0
in:	--	(0.354)	--	(0.492)	--	(0.180)	(0.185)	--	(0.197)	--	(0.354)

TABLE II. PERFORMANCE RATINGS @ 20°C (unless otherwise noted):

IHOLD (A)**	RESISTANCE (Ω) @ 20° C			TIME TO TRIP @ 1A		OPERATING TEMPERATURE (°C)	
	R MIN	R MAX	R _{1 MAX} *	TYP	MAX	MIN	MAX
20°C 0.150	6.0	10.0	17.0	1.4	4.0	-40	85

* Maximum device resistance at 20°C measured 1 hour post trip.

**Dependant on heat sinking.

Designed to assist equipment meet UL60950

Agency Approvals: UL, CSA
 Reference Documents: PS300
 Precedence: This specification takes precedence over documents referenced herein.
 Effectivity: Reference documents shall be the issue in effect on the date of invitation for bid.
 CAUTION: Operation beyond the rated voltage or current may result in rupture, electrical arcing or flame.