

Tyco / Electronics
Raychem Circuit Protection
 308 Constitution Drive
 Menlo Park, CA 94025-1164
 Phone: 800-227-4856
 Fax: 800-227-4866

PolySwitch®
PTC Devices
 Overcurrent Protection Device

PRODUCT: TRF250-145S

DOCUMENT: SCD 26224
 PCN: RF0028-000
 REV LETTER: B
 REV DATE: NOVEMBER 2, 2005
 PAGE NO.: 1 OF 1

Specification Status: Preliminary

Max Electrical Rating at 20°C

Operating Voltage: 60V_{DC}

Interrupt Current: 3A_{RMS}

Fault Voltage: 250V_{RMS}

Lead Material : 22 AWG Sn plated copper

Marking:

- Raychem Logo
- XX 45 — Part Identification
- — Lot Identification

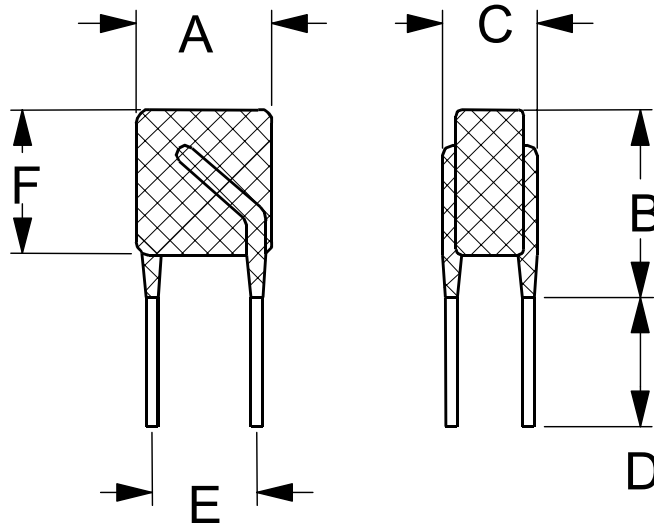

Center-to-Center

TABLE I. DIMENSIONS:

	A		B		C		D		E	F	
	MIN	MAX	MIN	MAX	MIN	MAX	MIN	MAX	NOM	MIN	MAX
mm:	--	6.5	--	10.0	--	4.6	4.7	--	5.0	--	7.0
in:	--	(0.256)	--	(0.393)	--	(0.180)	(0.185)	--	(0.197)	--	(0.276)

TABLE II. PERFORMANCE RATINGS @ 20°C (unless otherwise noted):

IHOLD (A)		RESISTANCE (Ω) @ 20° C			TIME TO TRIP (s) @ 1A
20°C	70°C	R MIN	R MAX	R _{1MAX} *	TYP
0.145	0.070	3.0	6.0	14.0	2.5

*Maximum device resistance at 20°C measured 1 hour post trip.

Additional Ratings @ 20°C

Lightning Withstand ITU K.21 at 1.5kV

Agency Recognition: UL, CSA, TUV pending
 Reference Documents: PS300
 Precedence: This specification takes precedence over documents referenced herein.
 Effectivity: Reference documents shall be the issue in effect on the date of invitation for bid.
 CAUTION: Operation beyond the rated voltage or current may result in rupture, electrical arcing or flame.

Materials Information

ROHS Compliant

ELV Compliant

Pb-Free

