

Specification Status: Released

Maximum Electrical Rating

Voltage: 6.0V_{DC}
Short Circuit Current: 100A

Notes:

1. All terminations are tin plated.
2. Drawing not to scale

Marking: T

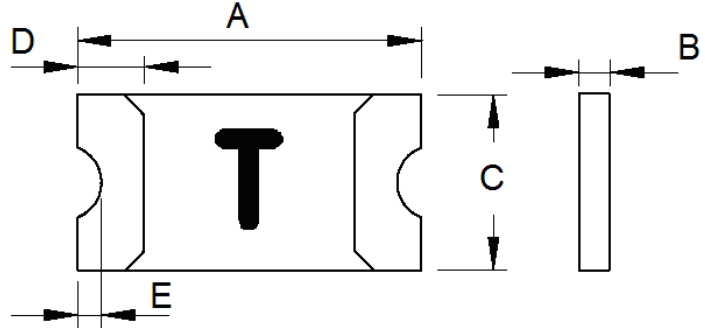

TABLE I. DIMENSIONS:

| A | | B | | C | | D | | E |
|---------|---------|---------|---------|---------|---------|---------|---------|---------|
| MIN | MAX | MIN | MAX | MIN | MAX | MIN | MAX | MIN |
| 3.00 | 3.40 | 0.83 | 1.10 | 1.37 | 1.80 | 0.25 | 0.75 | 0.076 |
| (0.118) | (0.134) | (0.033) | (0.043) | (0.054) | (0.071) | (0.010) | (0.030) | (0.003) |

mm:
in:

TABLE II. PERFORMANCE RATINGS:

| CURRENT RATINGS** | | | | | | TIME TO TRIP** | RESISTANCE VALUES | | TRIPPED-STATE POWER DISSIPATION** |
|-------------------|------|-----------------|------|-----------------|------|---------------------------|-------------------|-------|-----------------------------------|
| AMPERES AT 0°C | | AMPERES AT 25°C | | AMPERES AT 60°C | | SECONDS AT 25°C, 8.0A MAX | OHMS AT 25°C | | WATTS AT 25°C, 6.0V |
| HOLD | TRIP | HOLD | TRIP | HOLD | TRIP | | MIN | MAX* | MAX |
| 2.35 | 4.7 | 2.0 | 4.0 | 1.5 | 3.0 | 1.5 | 0.020 | 0.072 | 1.0 |

*Maximum resistance is measured 1 hour after reflow.

** Values specified were determined using PCB's with 0.040"X2.0 ounce copper traces.

Agency Recognitions: UL, CSA, TÜV
Reference Documents: PS300
Precedence: This specification takes precedence over documents referenced herein.
Effectivity: Reference documents shall be the issue in effect on the date of invitation for bid.
CAUTION: Operation beyond the rated voltage or current may result in rupture, electrical arcing or flame.

Materials Information

ROHS Compliant

Directive 2002/95/EC
Compliant

ELV Compliant

Directive 2000/53/EC
Compliant

Pb-Free



Halogen Free*



* Halogen Free refers to: Br≤900ppm, Cl≤900ppm, Br+Cl≤1500ppm.