

**Tyco / Electronics**  
**Raychem Circuit Protection**  
 308 Constitution Drive  
 Menlo Park, CA 94025-1164  
 Phone: 800-227-4856  
 Fax: 800-227-4866

**PolySwitch®**  
**PTC Devices**  
 Overcurrent Protection Device

**PRODUCT: TRF600-160-RA-B-0.5**

DOCUMENT: SCD 26269  
 PCN: RF0079-000, RF0078-000  
 REV LETTER: B  
 REV DATE: MARCH 30, 2006  
 PAGE NO.: 1 OF 1

**Specification Status: RELEASED**

**Max Electrical Rating at 20°C**

**Operating Voltage: 250V<sub>DC</sub>**

**Interrupt Current: 3A<sub>RMS</sub>**

**Fault Voltage: 600V<sub>RMS</sub>**

**Lead Material: 22 AWG Sn plated copper**  
 (0.65 mm [0.026"] nominal diameter)

**External Coating Material: Cured, flame retardant epoxy polymer, meeting UL94 V-0 requirements.**

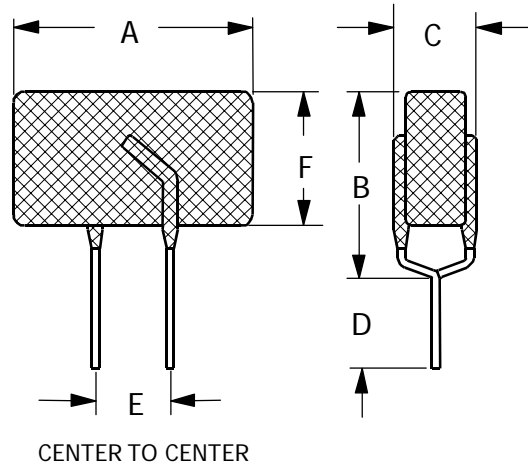

**Marking:**

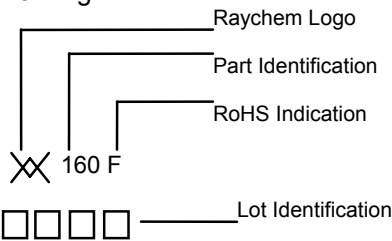

**TABLE I. DIMENSIONS:**

	A		B		C		D		E	F
	MIN	MAX	MIN	MAX	MIN	MAX	MIN	MAX	NOM	MAX
mm:	--	16.0	--	12.6	--	6.0	4.7	--	5.0	10.0
in:	--	(0.630)	--	(0.496)	--	(0.236)	(0.185)	--	(0.197)	(0.394)

**TABLE II. PERFORMANCE RATINGS @ 20°C (unless otherwise noted):**

I HOLD (A)	I TRIP (A)	RESISTANCE (Ω)			TIME TO TRIP (s) @ 1A	OPERATING TEMPERATURE (°C)	
		R MIN	R MAX	R <sub>1,MAX</sub> *		MIN	MAX
0.160	0.320	4.0	7.0	16.0	9.5	-40	85

\* Maximum device resistance @ 20°C measured 1 hour post trip.

**Additional Rating @ 20°C**

Resistance Matched 0.5 Ohm

Designed to assist equipment meet UL60950

Agency Recognition:

UL, CSA

Reference Documents:

PS300

Precedence:

This specification takes precedence over documents referenced herein.

Effectivity:

Reference documents shall be the issue in effect on the date of invitation for bid.

CAUTION:

Operation beyond the rated voltage or current may result in rupture, electrical arcing or flame.

**ROHS Compliant**

**ELV Compliant**

**Pb-Free**

Directive 2002/95/EC  
Compliant

Directive 2000/53/EC  
Compliant

