

JUMPERS

TYPE PL2-1U

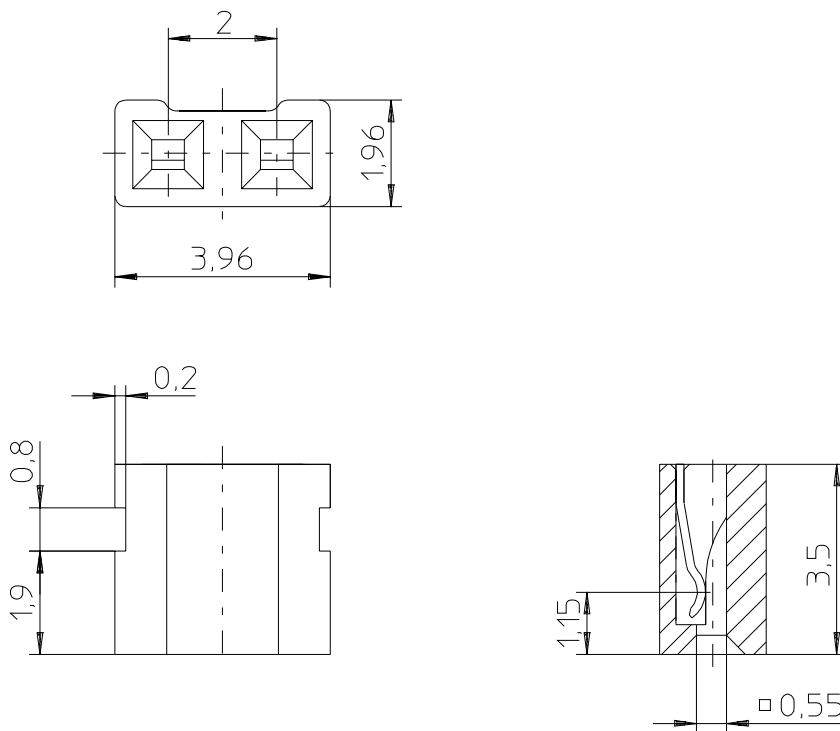
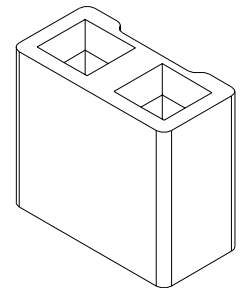
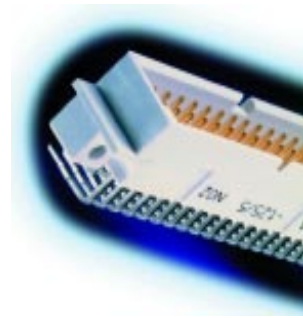

- Female connector mating with 0.5 ± 0.04 mm, square or round pins
- Used in most male headers and connectors
- Open top enables stacking of two or more Jumpers on the same pin and allows inspection of contacts and testing with a probe
- Available in different colours

Applications

- Bridging during testing
- Programming or choosing alternative operating modes
- Identification coding of apparatus
- Can be used as switches instead of DIL switches

TECHNICAL SPECIFICATIONS

MATERIALS	Connector body	Glass fiber filled polyester
	Contact	Phosphor bronze
	Contact plating	Nickel all over + hard gold MIL-G-45204 B
ELECTRIC DATA	Current rating	2 A at 80 °C
	Proof voltage	750 V (rms) 50 Hz
	Insulation resistance	$\geq 10^6 \text{ M}\Omega$
	Contact resistance	$\leq 15 \text{ m}\Omega$
PHYSICAL DATA	Temperature range	-55 °C...+125 °C
	Insertion force	$\leq 4 \text{ N}$
	Withdrawal force	$\geq 1 \text{ N}$
	Mechanical endurance	200 insertions (min)
	Recommended mating pin	
	- size	$0.5 \pm 0.04 \text{ mm}$, square or round
	- length	6 mm
	Flammability	UL 94 V-0

ORDERING CODE

PL2-1U - 0,8 - 1

PL2-1U	TYPE OF CONNECTOR
Two-part Jumper	PL2-1U

0,8	CONTACT FINISH
0.2 μm hard gold over 2 μm Ni	0.2
0.8 μm hard gold over 2 μm Ni	0.8
Other platings on request	...

1	COLOUR CODE
Grey (standard)	1
Green	2
Blue	3
Yellow	4
Red	5
Brown	6
Black	7
Other colours on request	...